

Performance scope

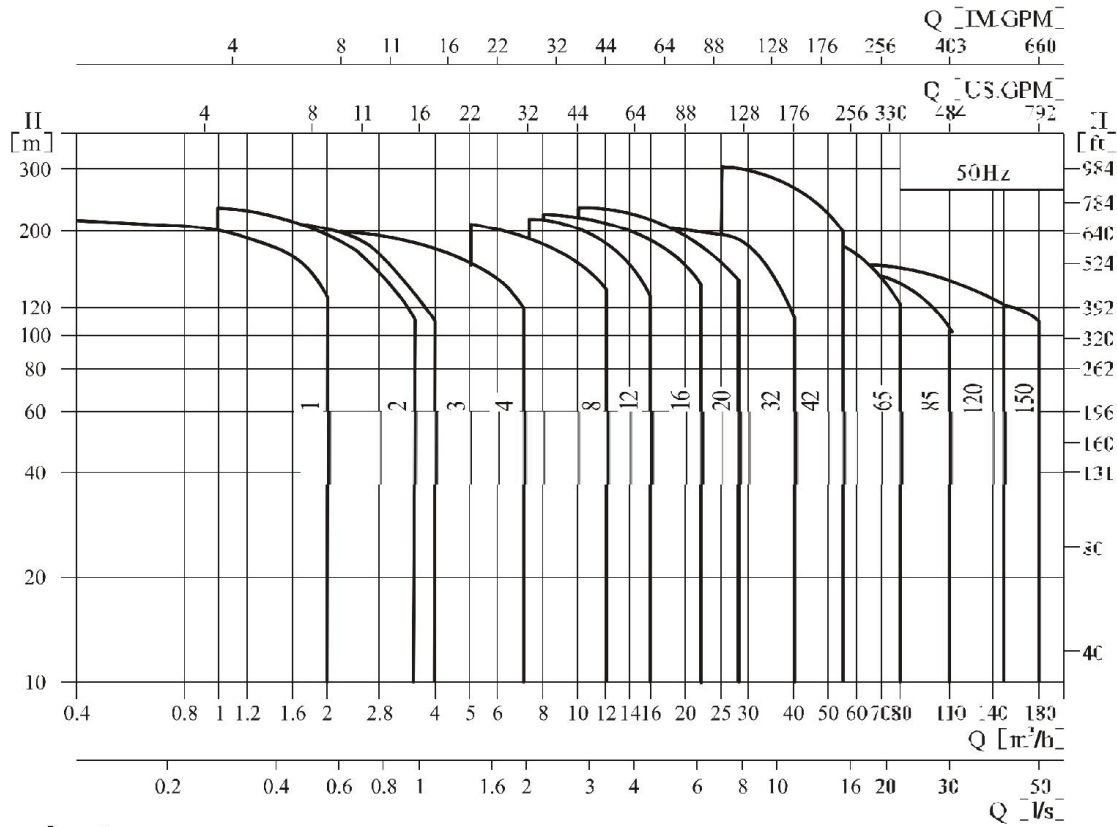

Product range

| Description | SHV1 | SHV2 | SHV3 | SHV4 | SHV8 | SHV12 | SHV16 | SHV20 | SHV32 | SHV42 | SHV65 | SHV85 | SHV120 | SHV150 |
|------------------------|-----------|-----------|----------|----------|----------|---------|---------|----------|----------|----------|----------|-----------|-----------|--------|
| Rated flow [m³/h] | 1 | 2 | 3 | 4 | 8 | 12 | 16 | 20 | 32 | 42 | 65 | 85 | 120 | 150 |
| Rated flow [l/s] | 0.28 | 0.56 | 0.83 | 1.1 | 2.2 | 3.3 | 4.4 | 5.6 | 8.9 | 11.7 | 18 | 24 | 33 | 41.6 |
| Flow range [m³/h] | 0.4-2 | 1-3.5 | 1.2-4 | 1.5-7 | 5-12 | 7-16 | 8-22 | 10-28 | 16-40 | 25-55 | 30-80 | 50-110 | 60-150 | 80-180 |
| Flow range [l/s] | 0.11-0.56 | 0.28-0.97 | 0.33-1.1 | 0.42-1.9 | 1.4-3.3 | 1.9-4.4 | 2.2-6.1 | 2.8-7.8 | 4.4-11.1 | 6.9-15.3 | 8.3-22.2 | 13.8-30.5 | 15.7-41.7 | 22-50 |
| Max. pressure [bar] | 21 | 23 | 22 | 21 | 21 | 22 | 22 | 23 | 26 | 30 | 22 | 17 | 16 | 16 |
| Motor power [kW] | 0.37-2.2 | 0.37-3 | 0.37-3 | 0.37-4 | 0.75-7.5 | 1.5-11 | 2.2-15 | 1.1-18.5 | 1.5-30 | 3.0-45 | 4.0-45 | 5.5-45 | 11-75 | 11-75 |
| Temperature range [°C] | -15~+120 | | | | | | | | | | | | | |
| Max. efficiency [%] | 44 | 46 | 54 | 59 | 64 | 63 | 66 | 69 | 76 | 78 | 80 | 81 | 74 | 73 |
| Type | | | | | | | | | | | | | | |
| SHV | ● | ● | ● | ● | ● | ● | ● | ● | ● | ● | ● | ● | ● | ● |
| | ● | ● | ● | ● | ● | ● | ● | ● | ● | ● | ● | ● | ● | ● |
| DIN Flange | DN25 | DN25 | DN25 | DN32 | DN40 | DN50 | DN50 | DN50 | DN65 | DN80 | DN100 | DN100 | DN125 | DN125 |
| Oval Flange | G1 | G1 | G1 | G1¼ | G1½ | | | | | | | | | |
| DIN Flange | DN25 | DN25 | DN25 | DN32 | DN40 | DN50 | DN50 | DN50 | DN65 | DN80 | DN100 | DN100 | DN125 | DN125 |
| Cutting ferrule joint | ● | ● | ● | ● | ● | ● | ● | ● | | | | | | |
| Pipe thread | ● | ● | ● | ● | ● | ● | ● | ● | | | | | | |

Company name
Respons. Department
E-mail address
Website

MOTOLOGY Electric Pte Ltd
2 Woodlands Sector 1, Singapore 738086
shaktipumpsg@gmail.com
shakti-pumps.com

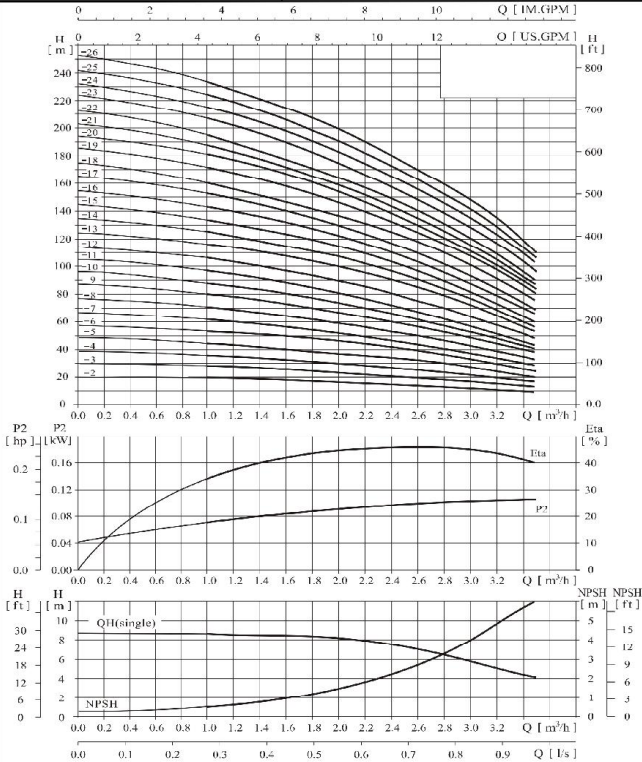

Operating data specification

| | |
|---------------------------|----------------|
| Nominal flow | m³/h 2.2 |
| Nominal head | m 55 |
| Static head | m 0 |
| NPSH - value of plant | m 0 |
| Inlet pressure | psi 1.42 |
| Fluid | Water, pure |
| Operating temperature t A | °F 68 |
| Density at t A | lb/ft³ 62.32 |
| Kin. viscosity at t A | ft²/s 1.082E-5 |

Pump

| | | |
|-----------------------|----------|----------|
| Pump name | SHV 2-15 | |
| Size | | |
| Design | | |
| Speed | rpm 2900 | |
| Impeller type | | |
| Flow | Nominal | m³/h 2.0 |
| | Max- | m³/h 3.5 |
| | Min- | m³/h 1 |
| Head | Nominal | m 112 |
| | Max- | m 134 |
| | Min- | m 60 |
| Head H(Q=0) | m 127 | |
| NPSH 3% | m 2.2 | |
| Max. working pressure | psi 181 | |
| Shaft power | hp 2 | |
| Efficiency | % 46 | |
| Max absorbed power | hp 2.5 | |

Materials Pump

| | |
|-----------------|--------------------------|
| Shaft | Stainless steel AISI 304 |
| Impeller | Stainless steel AISI 304 |
| Diffuser | Stainless steel AISI 304 |
| Coupling | Carbon steel |
| Pump head | Cast iron ASTM25B |
| Impeller sleeve | Stainless steel AISI 304 |

Dimensions in mm

● Installation sketch

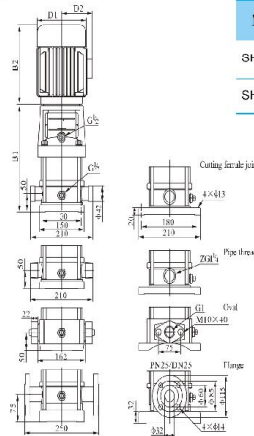

● Size and weight

| Model | Size (mm) | | | | Weight (kg) |
|---------|-----------|-----|-------|---------|-------------|
| | B1 | B2 | B1+B2 | D1 D2 | |
| SHV2-15 | 312 | 290 | 802 | 190 :53 | 36 |
| SHV2-18 | 566 | 290 | 856 | 190 :55 | 41 |



| | | | |
|----------------------|--------------------|------------------|----------|
| Manufacturer / Type | SHAKTI - SINGAPORE | | |
| Rated power | hp 2 | Efficiency | 4/4 |
| Electric current | A 4 | Speed | rpm 2900 |
| Electric voltage | V 400 V | 1~ | Hz 50 |
| Starting mode | Unknown | | |
| Degree of protection | IP 55 | Insulation class | F |

Remarks:

| | | | | |
|---------|------------|------------|---------------------------------|-------------|
| Project | Project ID | Created by | Created on 2014-06-23 | Last update |
|---------|------------|------------|---------------------------------|-------------|